

THIS DRAWING IS TO BE READ IN CONJUNCTION WITH ALL RELEVANT DRAWINGS, DETAILS AND WRITTEN SPECIFICATION.

NO DIMENSIONS ARE TO BE SCALED FROM THIS DRAWING.

DISCREPANCIES OR VARIATIONS ARE TO BE CHECKED BEFORE WORKS PROCEED.

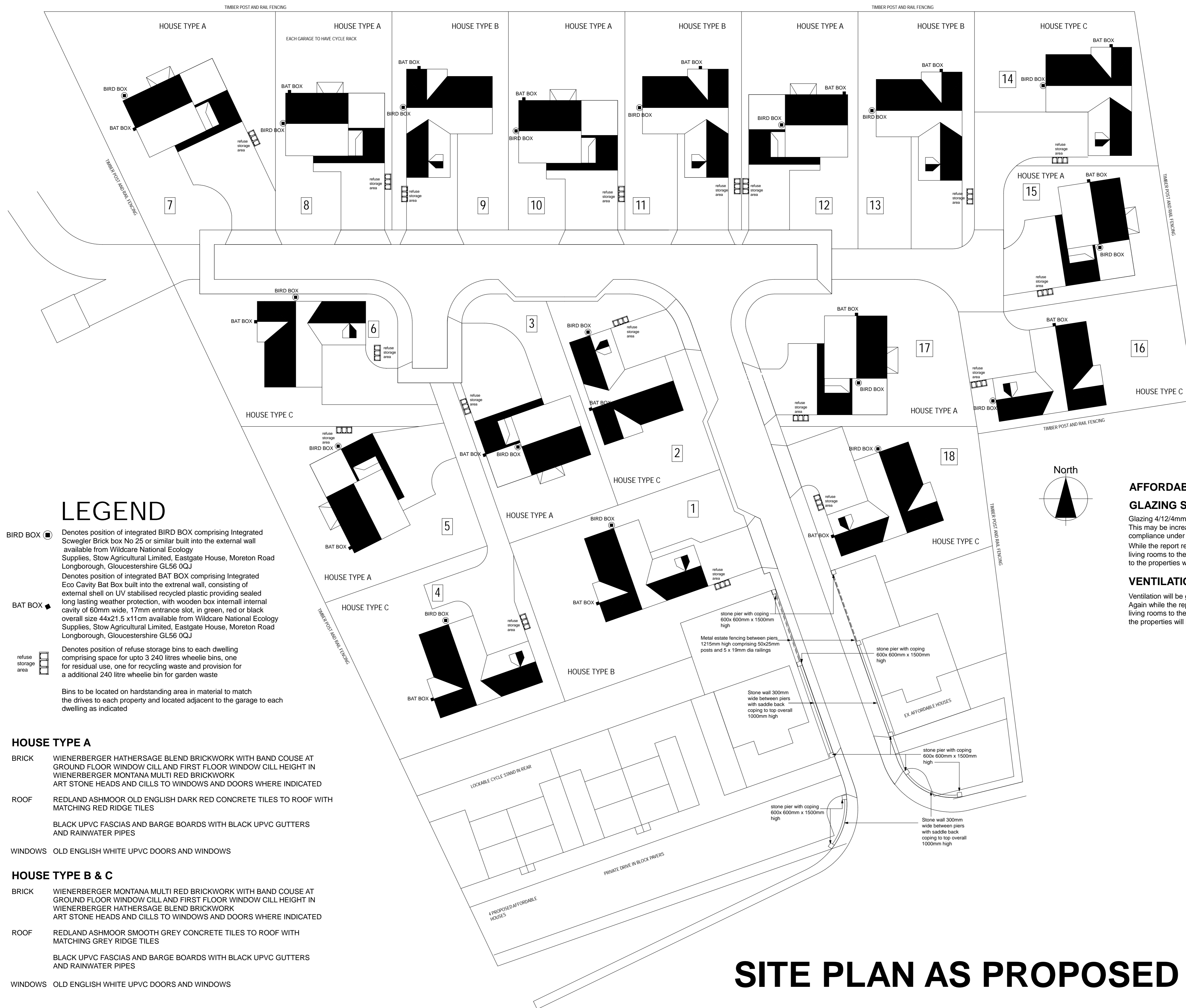

LEGEND

- BIRD BOX** Denotes position of integrated BIRD BOX comprising Integrated Scwegler Brick box No 25 or similar built into the external wall available from Wildcare National Ecology Supplies, Stow Agricultural Limited, Eastgate House, Moreton Road Longborough, Gloucestershire GL56 0QJ
 - BAT BOX** Denotes position of integrated BAT BOX comprising Integrated Eco Cavity Bat Box built into the external wall, consisting of external shell on UV stabilised recycled plastic providing sealed long lasting weather protection, with wooden box internal internal cavity of 60mm wide, 17mm entrance slot, in green, red or black overall size 44x21.5 x11cm available from Wildcare National Ecology Supplies, Stow Agricultural Limited, Eastgate House, Moreton Road Longborough, Gloucestershire GL56 0QJ
 - refuse storage area** Denotes position of refuse storage bins to each dwelling comprising space for upto 3 240 litres wheelie bins, one for residual use, one for recycling waste and provision for a additional 240 litre wheelie bin for garden waste
- Bins to be located on hardstanding area in material to match the drives to each property and located adjacent to the garage to each dwelling as indicated

HOUSE TYPE A

- BRICK** WIENERBERGER HATHERSAGE BLEND BRICKWORK WITH BAND COUSE AT GROUND FLOOR WINDOW CILL AND FIRST FLOOR WINDOW CILL HEIGHT IN WIENERBERGER MONTANA MULTI RED BRICKWORK ART STONE HEADS AND CILLS TO WINDOWS AND DOORS WHERE INDICATED
- ROOF** REDLAND ASHMOOR OLD ENGLISH DARK RED CONCRETE TILES TO ROOF WITH MATCHING RED RIDGE TILES
- BLACK UPVC FASCIAS AND BARGE BOARDS WITH BLACK UPVC GUTTERS AND RAINWATER PIPES
- WINDOWS** OLD ENGLISH WHITE UPVC DOORS AND WINDOWS

HOUSE TYPE B & C

- BRICK** WIENERBERGER MONTANA MULTI RED BRICKWORK WITH BAND COUSE AT GROUND FLOOR WINDOW CILL AND FIRST FLOOR WINDOW CILL HEIGHT IN WIENERBERGER HATHERSAGE BLEND BRICKWORK ART STONE HEADS AND CILLS TO WINDOWS AND DOORS WHERE INDICATED
- ROOF** REDLAND ASHMOOR SMOOTH GREY CONCRETE TILES TO ROOF WITH MATCHING GREY RIDGE TILES
- BLACK UPVC FASCIAS AND BARGE BOARDS WITH BLACK UPVC GUTTERS AND RAINWATER PIPES
- WINDOWS** OLD ENGLISH WHITE UPVC DOORS AND WINDOWS

AFFORDABLE HOUSING AND PLOTS 4, 5 & 7

GLAZING SPECIFICATION

Glazing 4/12/4mm double glazing as a minimum standard This may be increased if it is required to be undertaken to ensure compliance under part L and heat loss calculations for the property While the report requires the glazing to be used to all bedrooms and living rooms to the south and western perimeters, all of the windows to the properties will be fitted to the same specification

VENTILATION SPECIFICATION

Ventilation will be greenwoods EAR42W through frame trickle vents Again while the report requires that these be used to all bedroom and living rooms to the south and western perimeters, all of the windows in the properties will be fitted to the same

REV B - AUGUST 2019 BAT AND BIRD BOXES CHANGED, SPEC FOR VENTILATION AND GLAZING TO PLOTS 4,5 & 7 ADDED
REV A - JUNE 2019 PLOTS 11 AND 13 CHANGED TO HOUSE TYPE B DRIVES AMENDED ACCORDINGLY

PROJECT
LAND WEST OF VILLAGE HALL
ACKLINGTON VILLAGE
ACKLINGTON, NORTHUMBERLAND

TITLE
SITE PLAN AS PROPOSED

CLIENT
PIGDON FARM LTD

DATE
APRIL 2019

DRAWING No
A445/001B

SCALE
1:250 @ A1

Anthony Scullion
Architectural Services

51 Neptune Road
Dumpling Hall Estate
Newcastle upon Tyne
NE15 7XG

SITE PLAN AS PROPOSED